

Specification Sheet - Door Configuration #4

Trim and Cylinders for Multi Point Locks

Swinging Patio Door Hardware - Set includes Plates, Handles and Cylinders (where applicable)

Ashland®, Caradco®, Milgard®, Marvin®, PGT®

Keyed with American Cylinder (for Active Door, Schlage Keyway, Rekeyable)

1 1/2" x 11" Plates, Product Codes 1411, 1431, 1451, 1471, 1491

2" x 10" Plates, Product Codes 1421, 1441, 1461, 1481, 1401

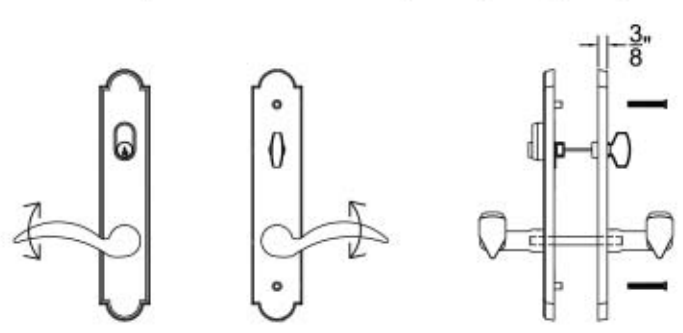
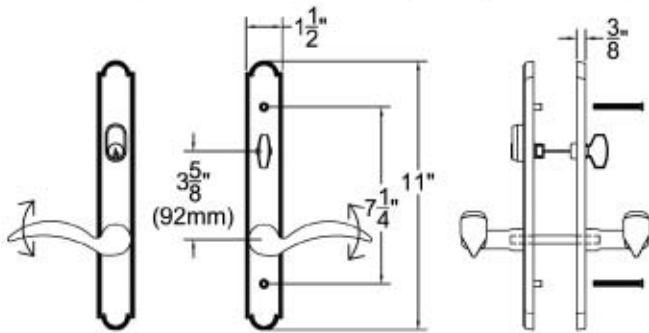

Non-Keyed, Passage (for Semi-Active Door)

1 1/2" x 11" Plates, Product Codes 1412, 1432, 1452, 1472, 1492

2" x 10" Plates, Product Codes 1422, 1442, 1462, 1482, 1402

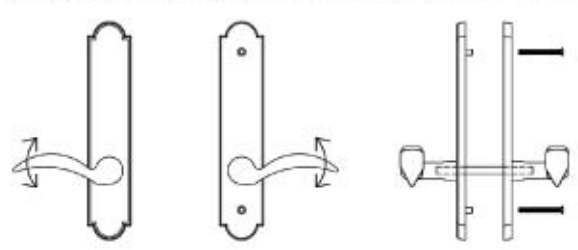
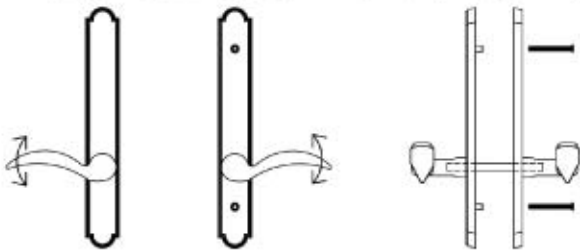

Non-Keyed, American Style Thumbturn Inside (for Active Door)

1 1/2" x 11" Plates, Product Codes 1413, 1433, 1453, 1473, 1493

2" x 10" Plates, Product Codes 1423, 1443, 1463, 1483, 1403

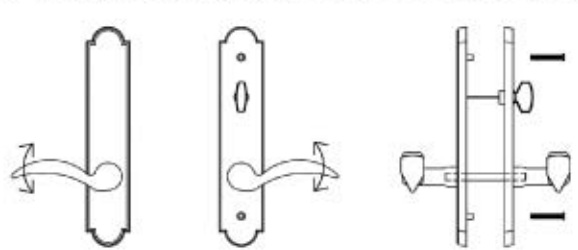
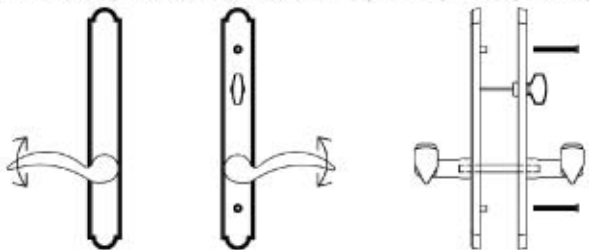

Non-Keyed, Fixed Handle Outside, Operating Handle Inside (for Semi-Active Door)

1 1/2" x 11" Plates, Product Codes 1414, 1434, 1454, 1474, 1494

2" x 10" Plates, Product Codes 1424, 1444, 1464, 1484, 1404

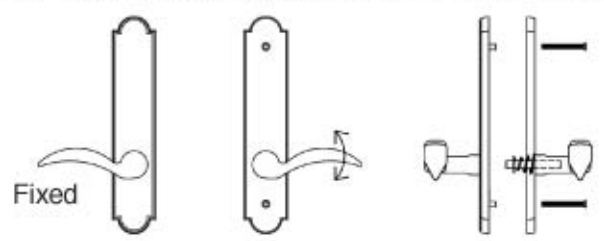
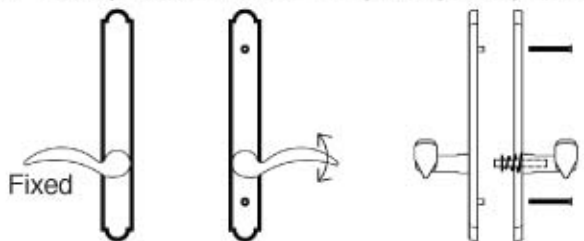

Dummy Pair (for Non-Active Door)

1 1/2" x 11" Plates, Product Codes 1415, 1435, 1455, 1475, 1495

2" x 10" Plates, Product Codes 1425, 1445, 1465, 1485, 1405

